

Multiple-orifice Solid Stream Jet Nozzles

2CCP·7CCP / 2CP·7CP

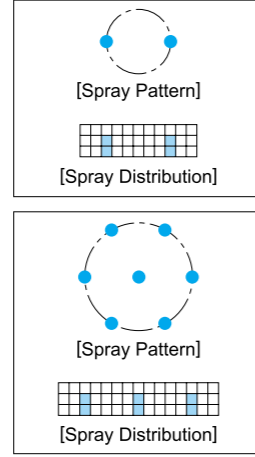
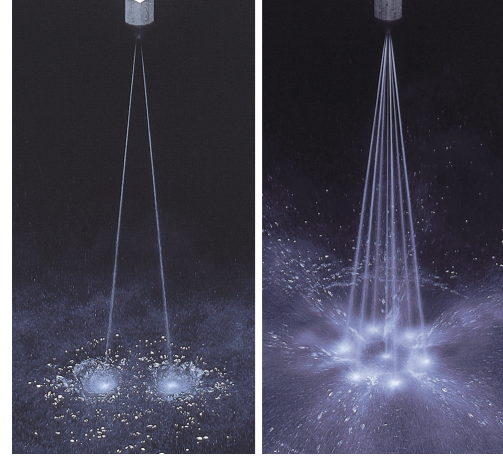

[Features]

- Multiple solid streams with high impact force.
- 2-orifice and 7-orifice types are available.
- Compact design.

[Standard Pressure]

1MPa

[Applications]

Cleaning : Wire and felt parts of paper making machines, dandy rolls, machine parts, bottles, vehicles, returnable containers, etc.

2CCP · 7CCP-series

2CCP · 7CCP-series	
Structure	• Made of metal, one-piece structure.
Material	• S303 (stainless steel 303) • Optional material : S420J2 (spray orifice only)

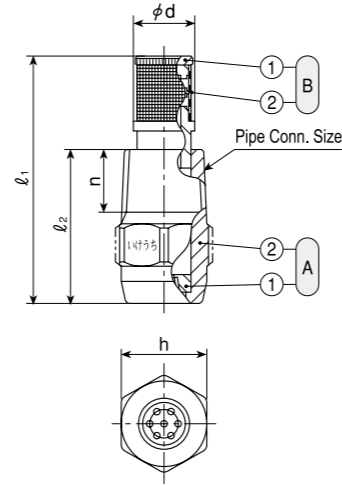

Series	Pipe Conn. Size	Dimensions(mm)					Mass (g)
		l ₁	l ₂	h	n	φ d	
2CCP · 7CCP	1/4M	40	26	14	10.5	10.0	16

* For 2CCP·7CCP with strainer, add 2-5g to the above mass.

[Note] Appearance and dimensions may differ slightly depending on materials and nozzle codes.

Ⓐ Nozzle (① Spray orifice ② Body)
Ⓑ Strainer (① Strainer holder ② Strainer screen)

2CP · 7CP-series

2CP · 7CP-series (with ceramic orifice inserted)	
Structure	• One-piece structure with ceramic orifice inserted.
Material	• Spray orifice : ceramic • Metal parts : S303 (stainless steel 303)

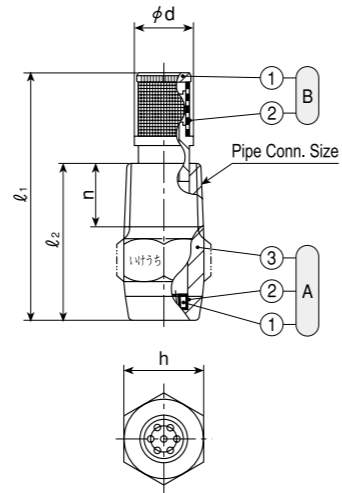

Series	Pipe Conn. Size	Dimensions(mm)					Mass (g)
		l ₁	l ₂	h	n	φ d	
2CP · 7CP	1/4M	40	26	14	10.5	10.0	17

* For 2CP·7CP with strainer, add 2-5g to the above mass.

[Note] Appearance and dimensions may differ slightly depending on materials and nozzle codes.

Ⓐ Nozzle (① Ceramic orifice ② Adhesive : Araldite® ③ Body)
Ⓑ Strainer (① Strainer holder ② Strainer screen)

Multiple-orifice Solid Stream Jet Nozzles 2CCP · 7CCP / 2CP · 7CP-series

2-orifice type

Spreading Angle Code	Spray Capacity Code	2CCP (Metal)		2CP (Ceramic orifice inserted)		Spreading Angle*			Spray Capacity (ℓ/min)					Free Pass. Dia. (mm)	Strainer Mesh Size
		1/4M	1/4M	0.5 MPa	1 MPa	2 MPa	0.3 MPa	0.5 MPa	0.7 MPa	1 MPa	1.5 MPa	2 MPa	3 MPa		
25°	09	●	●	25°	25°	25°	0.47	0.61	0.72	0.86	1.05	1.22	1.49	0.5	100
	12	●	●	25°	25°	25°	0.68	0.88	1.04	1.24	1.52	1.75	2.15	0.6	100
	17	●	●	25°	25°	25°	0.92	1.19	1.41	1.68	2.06	2.38	2.91	0.7	50
	22	●	●	25°	25°	25°	1.19	1.54	1.82	2.18	2.67	3.08	3.78	0.8	50
15°	09	○	○	15°	15°	15°	0.47	0.61	0.72	0.86	1.05	1.22	1.49	0.5	100
	12	○	○	15°	15°	15°	0.68	0.88	1.04	1.24	1.52	1.75	2.15	0.6	100
	17	○	○	15°	15°	15°	0.92	1.19	1.41	1.68	2.06	2.38	2.91	0.7	50
	22	○	○	15°	15°	15°	1.19	1.54	1.82	2.18	2.67	3.08	3.78	0.8	50
10°	09	○	○	10°	10°	10°	0.47	0.61	0.72	0.86	1.05	1.22	1.49	0.5	100
	12	○	○	10°	10°	10°	0.68	0.88	1.04	1.24	1.52	1.75	2.15	0.6	100
	17	○	○	10°	10°	10°	0.92	1.19	1.41	1.68	2.06	2.38	2.91	0.7	50
	22	○	○	10°	10°	10°	1.19	1.54	1.82	2.18	2.67	3.08	3.78	0.8	50
34	○	○	○	10°	10°	10°	1.87	2.42	2.86	3.42	4.19	4.84	5.92	1.0	—

7-orifice type

Spreading Angle Code	Spray Capacity Code	7CCP (Metal)		7CP (Ceramic orifice inserted)		Spreading Angle*			Spray Capacity (ℓ/min)					Free Pass. Dia. (mm)	Strainer Mesh Size
		1/4M	1/4M	0.5 MPa	1 MPa	2 MPa	0.3 MPa	0.5 MPa	0.7 MPa	1 MPa	1.5 MPa	2 MPa	3 MPa		
15°	30	●	●	15°	15°	15°	1.65	2.13	2.52	3.01	3.69	4.26	5.21	0.5	100
	43	●	●	15°	15°	15°	2.38	3.07	3.63	4.34	5.32	6.14	7.52	0.6	100
	59	●	●	15°	15°	15°	3.22	4.16	4.92	5.88	7.20	8.32	10.2	0.7	50
	76	●	●	15°	15°	15°	4.18	5.40	6.38	7.63	9.34	10.8	13.2	0.8	50
	119	○	○	15°	15°	15°	6.52	8.41	9.96	11.9	14.6	16.8	20.6	1.0	—

●.....With strainer ○.....Without strainer

* [Note] Spreading angle means the angle between solid streams.

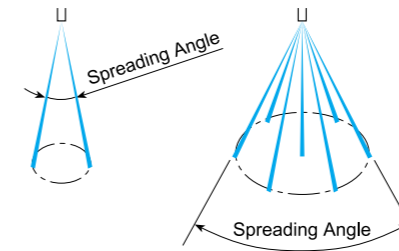

How to order

Please inquire or order for a specific nozzle using this coding system.

① 2-orifice type

<Example>...1/4M2CCP2517S303W

1/4M	2CCP	25	17	S303	W
Series	Spreading Angle Code	Spray Capacity Code	Strainer		
2CCP	25°	09	W (with Strainer)		
2CP	15°	∅	— (without Strainer)		
	10°	34			

② 7-orifice type

<Example>...1/4M7CCP1559S303W

1/4M	7CCP	15	59	S303	W
Series	Spreading Angle Code	Spray Capacity Code	Strainer		
7CCP	15°	30	W (with Strainer)		
7CP	∅	∅	— (without Strainer)		
		119			