



UGELLI PER ARIA E VAPORE C5 - CD3

C5 - CD3 AIR AND STEAM NOZZLES
 BOQUILLAS PARA AIRE Y VAPOR C5-CD3

Caratteristiche

- Ugelli a testina intercambiabile C5 o a corpo unico CD3 per spruzzo di aria o vapore
- Tipo C5 assemblabile con gli accessori

Characteristics

- C5 interchangeable spray tip or CD3 one piece nozzle to use with air or steam
- C5 type can be assembled with accessories

Características

- Boquillas con orificio intercambiabile C5 o de una sola pieza CD3 para pulverización de aire o de vapor
- El tipo C5 se puede montar con los accesorios

Come ordinare

Es. 1/4" C5 -1 OTTONE

How to Order

E.g. 1/4" C5 -1 BRASS

Para pedidos

Ej. 1/4" C5 -1 LATON



CD3



C5

MATERIALE MATERIAL MATERIAL	ATTACCO THREAD ROSCA DE CONEXIÓN	MODELLO MODEL MODELO	ORIFIZIO FLOW ORIFICE ORIFICIO	ANGOLO ANGLE ANGULO	CODICE ARTICLE CODE CÓDIGO
-----------------------------------	--	----------------------------	--------------------------------------	---------------------------	----------------------------------

O 1 C51 - - O1C51

DIMENSIONI - DIMENSIONS - DIMENSIONES (mm)

Ø	L	L1	L2 max
1/8	-	-	31
1/4	46	48	34
3/8	46	48	45

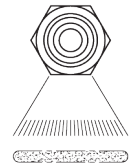
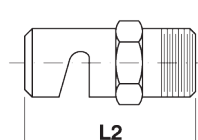
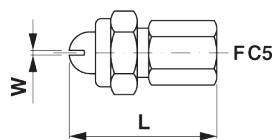
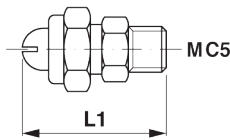

TIPO DI UGELLO TYPE OF NOZZLE TIPOS DE BOQUILLAS	W mm	PRESSIONE - PRESSURE - PRESIÓN (bar)										bar													
		0.7					2					4					7					1		4	
		Aria - Air - Aire (l/min)					Vapore - Steam - Vapor (kg/h)					°		°											
1/4 F - C5 - 1	1/4 M - C5 - 1	0.20	21	38	65	101	0.7	1.4	2.2	3.60	65	85													
1/4 F - C5 - 2	1/4 M - C5 - 2	0.38	40	60	100	152	1.5	2.0	3.5	5.50	70	80													
1/4 F - C5 - 3	1/4 M - C5 - 3	0.58	77	110	190	305	2.8	4.1	6.7	11.5	80	80													
1/4 F - C5 - 4	1/4 M - C5 - 4	1.1	131	199	345	540	4.5	7.2	12.3	19.4	70	70													
1/4 F - C5 - 5	1/4 M - C5 - 5	1.4	210	335	570	881	7.50	12.0	20.3	32.1	60	70													
1/4 F - C5 - 6	1/4 M - C5 - 6	2.3	430	700	1150	1724	15.5	25.0	42.0	63.0	60	70													
3/8 F - C5 - 1	3/8 M - C5 - 1	0.20	21	38	65	101	0.7	1.4	2.2	3.60	65	85													
3/8 F - C5 - 2	3/8 M - C5 - 2	0.33	40	60	100	152	1.5	2.0	3.5	5.50	70	80													
3/8 F - C5 - 3	3/8 M - C5 - 3	0.58	77	110	190	305	2.8	4.1	6.7	11.5	80	80													
3/8 F - C5 - 4	3/8 M - C5 - 4	1.1	131	199	345	540	4.5	7.2	12.3	19.4	70	70													
3/8 F - C5 - 5	3/8 M - C5 - 5	1.4	210	335	570	881	7.50	12.0	20.3	32.1	60	70													
3/8 F - C5 - 6	3/8 M - C5 - 6	2.3	430	700	1150	1724	15.5	25.0	42.0	63.0	60	70													

TIPO DI UGELLO TYPE OF NOZZLE TIPOS DE BOQUILLAS	Ø1 mm	PRESSIONE - PRESSURE - PRESIÓN (bar)										bar																		
		0.7					1.5					2					3					3.5					0.7		3.5	
		Aria - Air - Aire (l/min)					Vapore - Steam - Vapor (kg/h)					°		°																
* 1/8 - CD3 - 0.50	0.6	4.5	6.5	7.6	10.5	11.5	0.15	0.23	0.26	0.37	0.40	17	39																	
* 1/8 - CD3 - 0.75	0.75	6.1	9.0	10.8	14.7	16.6	0.23	0.33	0.39	0.52	0.60	20	44																	
* 1/8 - CD3 - 1	0.8	9.50	13.7	16.5	22.0	25.0	0.35	0.50	0.59	0.80	0.91	23	48																	
1/8 - CD3 - 1.5	1.0	15.3	22.0	26.0	36.0	40.0	0.55	0.78	0.95	1.30	1.50	25	51																	
1/8 - CD3 - 2	1.2	19.3	28.0	33.0	45.0	51.0	0.68	1.10	1.25	1.60	1.80	32	55																	
1/8 - CD3 - 3	1.4	31.0	46.0	55.0	77.0	85.0	1.10	1.70	2.00	2.70	3.10	33	60																	
1/8 - CD3 - 5	1.9	54.0	76.0	91.0	125	139	1.90	2.70	3.30	4.50	5.00	39	64																	
1/8 - CD3 - 7.5	2.3	80.0	117	140	190	210	3.00	4.10	5.00	6.80	7.50	39	68																	
1/8 - CD3 - 10	2.6	110	160	190	255	290	3.90	5.70	6.80	9.20	10.5	39	70																	
1/8 - CD3 - 15	3.3	180	261	310	420	475	6.50	9.30	11.2	15.0	17.1	41	72																	
1/8 - CD3 - 18	3.6	205	300	355	485	540	7.50	10.6	12.7	17.5	19.6	44	74																	
1/4 - CD3 - 20	3.6	225	325	386	520	590	8.10	11.5	13.7	18.7	20.9	46	78																	
3/8 - CD3 - 30	4.6	320	465	560	760	850	11.5	16.8	20.0	27.0	30.0	53	81																	
3/8 - CD3 - 40	5.3	440	640	760	1050	1160	15.7	22.8	27.0	36.8	42.0	58	85																	

* materiali su richiesta - material on request - bajo pedido