

UGELLI TANGENZIALI A CONO VUOTO - SERIE F TANGENTIAL FEED HOLLOW-CONE NOZZLES – F SERIES

F

CODE
MAT.
06 Ottone/Brass



Tipo / Type F5 3/8" BSPT



Tipo / Type F6 1/2" BSP



Tipo / Type F6 1/2" BSPT



Tipo / Type F7 3/4"-1" BSP



Tipo / Type F5FR

CARATTERISTICHE

- Ricavati da fusione in conchiglia
- Buona resistenza all'usura
- Privo di diffusore
- Vasta gamma di portate
- Angolo ampio fino a 150°
- Getto uniforme
- Gocce di medie e grosse dimensioni

APPLICAZIONI CONSIGLIATE

- Lavaggio e raffreddamento aria e gas
- Cabine di verniciatura
- Impianti di raffreddamento
- Sistemi antincendio
- Abbattimento schiume
- Spruzzatura di bitume asfaltico

CHARACTERISTICS

- Made out of chilling
- Wear resistance
- Without swirl disc
- Wide range of flows
- Wide spray angle up to 150°
- Uniform jet
- Medium and big sized droplets

TYPICAL APPLICATIONS

- Air and gas cooling and washing
- Spray booths
- Cooling plants
- Fire-fighting systems
- Foam-suppression
- Asphalt bitumen spraying

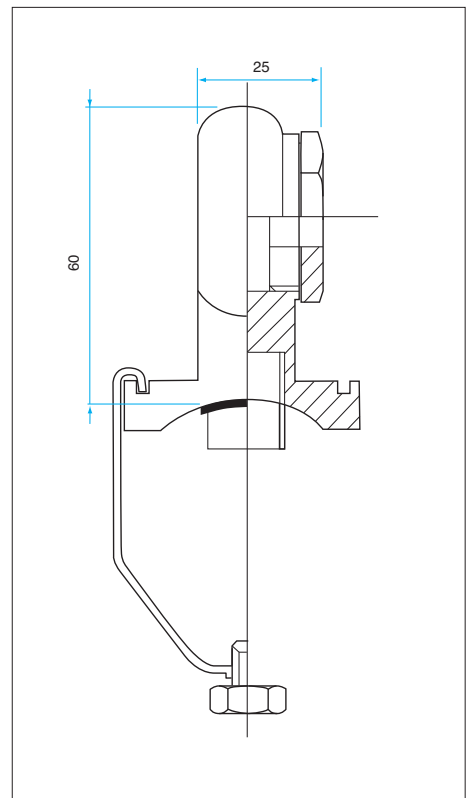
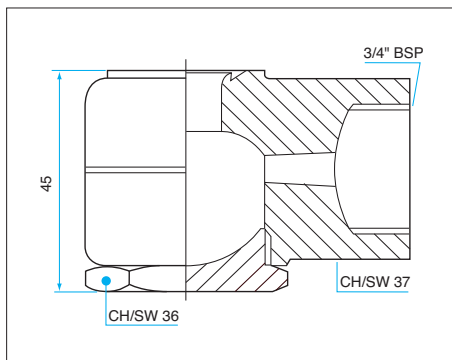
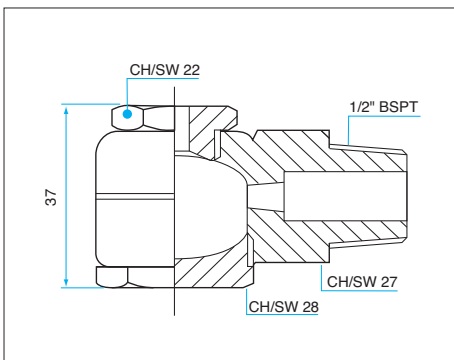
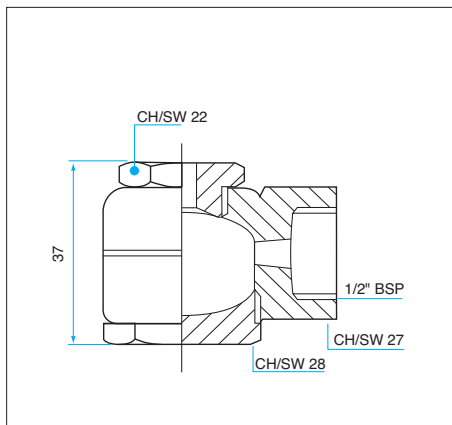
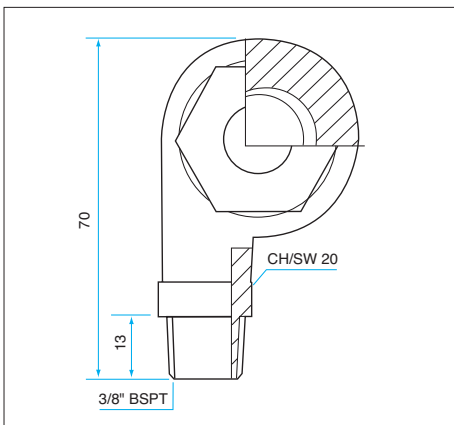

UGELLI TANGENZIALI A CONO VUOTO - SERIE F TANGENTIAL FEED HOLLOW-CONE NOZZLES – F SERIES

F

DATI OPERATIVI - OPERATIVE DATA

DIMENSIONI RACCORDO THREAD DIMENSIONS	TIPO / TYPE				CODICE PORTATA FLOW CODE	Ø E mm.	Ø U mm.	PORTATA / FLOW l/min									AMPIEZZA ANGOLO DI SPRUZZO SPRAY ANGLE WIDTH				
	F5y	F5FR	F6 x	F7 x				0,5 bar	1 bar	1,5 bar	2 bar	2,5 bar	3 bar	4 bar	5 bar	6 bar	45°	60°	90°	120°	150°
3/8" BSPT	▼				215	5,50	12,00	6,25	8,84	10,83	12,50	13,98	15,31	17,68	19,76	21,65			●		●
	▼				225	5,50	13,00	6,75	9,55	11,69	13,50	15,09	16,53	19,09	21,35	23,38			●		●
	▼				300	5,50	16,00	10,50	14,85	18,19	21,00	23,48	25,72	29,70	33,20	36,37			●		●
	▼				320	6,50	15,00	11,50	16,26	19,92	23,00	25,71	28,17	32,53	36,37	39,84			●		●
	▼				350	6,50	16,00	13,00	18,38	22,52	26,00	29,07	31,84	36,77	41,11	45,03			●		●
	▼				400	8,00	16,00	15,50	21,92	26,85	31,00	34,66	37,97	43,84	49,02	53,69			●		●
	▼				420	9,00	16,00	20,50	28,99	35,51	41,00	45,84	50,21	57,98	64,83	71,01			●		●
1/2" BSP			▼		148	5,00	5,50	2,90	4,10	5,02	5,80	6,48	7,10	8,20	9,17	10,05	●	●	●		
			▼		162	5,80	6,00	3,60	5,09	6,24	7,20	8,05	8,82	10,18	11,38	12,47	●	●	●		
			▼		185	6,50	8,00	4,75	6,72	8,23	9,50	10,62	11,64	13,44	15,02	16,45	●	●	●		
			▼		200	7,50	8,50	5,50	7,78	9,53	11,00	12,30	13,47	15,56	17,39	19,05	●	●	●		
			▼		220	7,50	9,00	6,50	9,19	11,26	13,00	14,53	15,92	18,38	20,55	22,52	●	●	●		
			▼		240	8,00	9,50	7,50	10,61	12,99	15,00	16,77	18,37	21,21	23,72	25,98	●	●	●		
			▼		270	9,50	10,00	9,00	12,73	15,59	18,00	20,12	22,05	25,46	28,46	31,18	●	●	●		
1/2" BSPT			▼		148	4,00	8,00	2,90	4,10	5,02	5,80	6,48	7,10	8,20	9,17	10,05				●	●
			▼		162	4,50	9,50	3,60	5,09	6,24	7,20	8,05	8,82	10,18	11,38	12,47				●	●
			▼		185	5,00	10,00	4,75	6,72	8,23	9,50	10,62	11,64	13,44	15,02	16,45				●	●
			▼		200	5,30	10,50	5,50	7,78	9,53	11,00	12,30	13,47	15,56	17,39	19,05				●	●
			▼		220	5,50	11,00	6,50	9,19	11,26	13,00	14,53	15,92	18,38	20,55	22,52				●	●
			▼		240	6,00	13,00	7,50	10,61	12,99	15,00	16,77	18,37	21,21	23,72	25,98				●	●
			▼		270	6,50	16,00	9,00	12,73	15,59	18,00	20,12	22,05	25,46	28,46	31,18				●	●
3/4" 1" BSP			▼		240	8,00	9,50	7,50	10,61	12,99	15,00	16,77	18,37	21,21	23,72	25,98		●	●		
			▼		270	9,50	10,00	9,00	12,73	15,59	18,00	20,12	22,05	25,46	28,46	31,18		●	●		
			▼		310	10,00	10,50	11,00	15,56	19,05	22,00	24,60	26,94	31,11	34,79	38,11		●	●		
			▼		355	10,00	11,00	13,25	18,74	22,95	26,50	29,63	32,46	37,48	41,90	45,90		●	●		
			▼		404	10,50	12,00	16,50	23,33	28,58	33,00	36,90	40,42	46,67	52,18	57,16		●	●		
			▼		418	11,50	12,50	20,00	28,28	34,64	40,00	44,72	48,99	56,57	63,25	69,28		●	●		
			▼		240	6,00	13,00	7,50	10,61	12,99	15,00	16,77	18,37	21,21	23,72	25,98				●	●
1"1/2" Ø TUBO PIPE	▼				215	5,50	12,00	6,25	8,84	10,83	12,50	13,98	15,31	17,68	19,76	21,65			●		●
	▼				225	5,50	13,00	6,75	9,55	11,69	13,50	15,09	16,53	19,09	21,35	23,38			●		●
	▼				300	5,50	16,00	10,50	14,85	18,19	21,00	23,48	25,72	29,70	33,20	36,37			●		●
	▼				320	6,50	15,00	11,50	16,26	19,92	23,00	25,71	28,17	32,53	36,37	39,84			●		●
	▼				350	6,50	16,00	13,00	18,38	22,52	26,00	29,07	31,84	36,77	41,11	45,03			●		●
	▼				400	8,00	16,00	15,50	21,92	26,85	31,00	34,66	37,97	43,84	49,02	53,69			●		●
	▼				420	9,00	16,00	20,50	28,99	35,51	41,00	45,84	50,21	57,98	64,83	71,01			●		●