

R SERIES

High capacity hollow cone spray nozzles

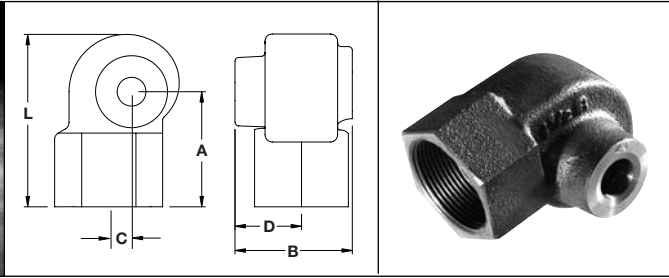

DIMENSIONS

| MODEL NUMBER (BSPT) | Dim. A (mm) | Dim. B (mm) | Dim. C (mm) | Dim. D (mm) | Dim. L (mm) |
|---------------------------------|-------------|-------------|-------------|-------------|-------------|
| 1R | 51 | 51 | 3.2 | 29 | 70 |
| 1 ¹ / ₄ R | 51 | 57 | 12.7 | 32 | 79 |
| 1 ¹ / ₂ R | 60 | 76 | 14.3 | 45 | 95 |
| 2R | 70 | 98 | 25.4 | 57 | 121 |
| 2 ¹ / ₂ R | 89 | 121 | 28.6 | 70 | 134 |

At 1 bar: Circular distribution with larger flow rates.

SPRAY CHARACTERISTICS:

A high capacity hollow cone spray pattern with uniform distribution. The large body and orifice diameters minimize clogging.

CONSTRUCTION:

One piece cast construction. Standard material is 316 stainless steel. All the R series nozzles have a female BSPT pipe connection. Bronze and cast iron available on a limited, special order basis.

TYPICAL APPLICATIONS:

- Aeration & Pollution Control
- Cooling Ponds
- Scrubbing and Washing Gases and Fumes
- Cooling Coil
- Dust Proofing
- Chemical Processes

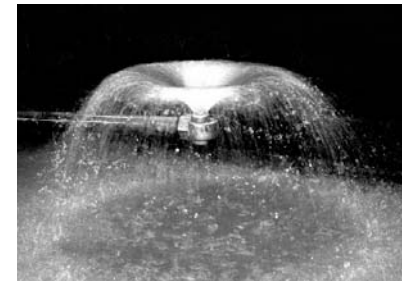

At 0.07 bar: Wide spray angle with large droplets and minimal misting.

HOLLOW CONE SPRAY

| MODEL NUMBER | PIPE SIZE BSPT | MAXIMUM FREE PASSAGE (mm) | CAPACITY (L/min) AT VARIOUS PRESSURES (bar) | | | | | | | | | | | | SPRAY ANGLE @ | | |
|------------------------------------|-------------------------------|---------------------------|---|---------|---------|---------|---------|-------|---------|-------|-------|-------|-------|-------|---------------|---------|-------|
| | | | 0.1 bar | 0.2 bar | 0.3 bar | 0.5 bar | 0.7 bar | 1 bar | 1.5 bar | 2 bar | 3 bar | 4 bar | 5 bar | 7 bar | 0.5 bar | 1.5 bar | 4 bar |
| 1R10 | 1 | 12.7 | 14.4 | 20.4 | 25.0 | 32 | 38 | 46 | 56 | 64 | 79 | 91 | 102 | 121 | 65° | 72° | 73° |
| 1R12 | 1 | 12.7 | 17.3 | 24.5 | 30.0 | 39 | 46 | 55 | 67 | 77 | 95 | 109 | 122 | 145 | 71° | 74° | 75° |
| 1R14 | 1 | 12.7 | 20.2 | 28.5 | 35 | 45 | 53 | 64 | 78 | 90 | 111 | 128 | 143 | 169 | 74° | 79° | 80° |
| 1R16 | 1 | 12.7 | 23.1 | 33 | 40 | 52 | 61 | 73 | 89 | 103 | 126 | 146 | 163 | 193 | 77° | 83° | 83° |
| 1R18 | 1 | 12.7 | 25.9 | 37 | 45 | 58 | 69 | 82 | 100 | 116 | 142 | 164 | 183 | 217 | 80° | 86° | 76° |
| 1 ¹ / ₄ R12 | 1 ¹ / ₄ | 13.1 | 17.3 | 24.5 | 30.0 | 39 | 46 | 55 | 67 | 77 | 95 | 109 | 122 | 145 | 64° | 68° | 69° |
| 1 ¹ / ₄ R14 | 1 ¹ / ₄ | 14.3 | 20.2 | 28.5 | 35 | 45 | 53 | 64 | 78 | 90 | 111 | 128 | 143 | 169 | 66° | 71° | 71° |
| 1 ¹ / ₄ R16 | 1 ¹ / ₄ | 14.3 | 23.1 | 33 | 40 | 52 | 61 | 73 | 89 | 103 | 126 | 146 | 163 | 193 | 71° | 75° | 75° |
| 1 ¹ / ₄ R18 | 1 ¹ / ₄ | 14.3 | 25.9 | 37 | 45 | 58 | 69 | 82 | 100 | 116 | 142 | 164 | 183 | 217 | 76° | 78° | 79° |
| 1 ¹ / ₄ R21 | 1 ¹ / ₄ | 14.3 | 30.3 | 43 | 52 | 68 | 80 | 96 | 117 | 135 | 166 | 191 | 214 | 253 | 79° | 82° | 82° |
| 1 ¹ / ₄ R24 | 1 ¹ / ₄ | 14.3 | 35 | 49 | 60 | 77 | 92 | 109 | 134 | 155 | 189 | 219 | 245 | 289 | 81° | 76° | 86° |
| 1 ¹ / ₂ R18 | 1 ¹ / ₂ | 15.5 | 25.9 | 37 | 45 | 58 | 69 | 82 | 100 | 116 | 142 | 164 | 183 | 217 | 66° | 70° | 71° |
| 1 ¹ / ₂ R21 | 1 ¹ / ₂ | 17.5 | 30.3 | 43 | 52 | 68 | 80 | 96 | 117 | 135 | 166 | 191 | 214 | 253 | 70° | 74° | 74° |
| 1 ¹ / ₂ R24 | 1 ¹ / ₂ | 18.8 | 35 | 49 | 60 | 77 | 92 | 109 | 134 | 155 | 189 | 219 | 245 | 289 | 73° | 76° | 76° |
| 1 ¹ / ₂ R28 | 1 ¹ / ₂ | 18.8 | 40 | 57 | 70 | 90 | 107 | 128 | 156 | 180 | 221 | 255 | 285 | 338 | 76° | 79° | 80° |
| 1 ¹ / ₂ R32 | 1 ¹ / ₂ | 18.8 | 46 | 65 | 80 | 103 | 122 | 146 | 179 | 206 | 253 | 292 | 326 | 386 | 79° | 84° | 84° |
| 1 ¹ / ₂ R37 | 1 ¹ / ₂ | 18.8 | 53 | 75 | 92 | 119 | 141 | 169 | 207 | 238 | 292 | 337 | 377 | 446 | 84° | 88° | 88° |
| 2R37 | 2 | 21.6 | 53 | 75 | 92 | 119 | 141 | 169 | 207 | 238 | 292 | 337 | 377 | 446 | 62° | 64° | 65° |
| 2R43 | 2 | 23.5 | 62 | 88 | 107 | 139 | 164 | 196 | 240 | 277 | 339 | 392 | 438 | 519 | 66° | 70° | 72° |
| 2R49 | 2 | 25.7 | 71 | 100 | 122 | 158 | 187 | 223 | 274 | 316 | 387 | 447 | 499 | 591 | 70° | 72° | 73° |
| 2R57 | 2 | 25.7 | 82 | 116 | 142 | 184 | 217 | 260 | 318 | 367 | 450 | 520 | 581 | 687 | 74° | 77° | 77° |
| 2R65 | 2 | 25.7 | 94 | 132 | 162 | 209 | 248 | 296 | 363 | 419 | 513 | 593 | 662 | 784 | 75° | 79° | 79° |
| 2R75 | 2 | 25.7 | 108 | 153 | 187 | 242 | 286 | 342 | 419 | 483 | 592 | 684 | 764 | 904 | 78° | 81° | 81° |
| 2R86 | 2 | 25.7 | 124 | 175 | 215 | 277 | 328 | 392 | 480 | 554 | 679 | 784 | 876 | 1037 | 86° | 88° | 88° |
| 2 ¹ / ₂ R75 | 2 ¹ / ₂ | 33.3 | 108 | 153 | 187 | 242 | 286 | 342 | 419 | 483 | 592 | 684 | 764 | 904 | 67° | 72° | 72° |
| 2 ¹ / ₂ R86 | 2 ¹ / ₂ | 33.3 | 124 | 175 | 215 | 277 | 328 | 392 | 480 | 554 | 679 | 784 | 876 | 1037 | 73° | 76° | 76° |
| 2 ¹ / ₂ R100 | 2 ¹ / ₂ | 33.3 | 144 | 204 | 250 | 322 | 381 | 456 | 558 | 645 | 789 | 912 | 1019 | 1206 | 79° | 83° | 84° |
| 2 ¹ / ₂ R115 | 2 ¹ / ₂ | 33.3 | 166 | 234 | 287 | 371 | 439 | 524 | 642 | 741 | 908 | 1048 | 1172 | 1387 | 80° | 84° | 85° |
| 2 ¹ / ₂ R132 | 2 ¹ / ₂ | 33.3 | 190 | 269 | 330 | 425 | 503 | 602 | 737 | 851 | 1042 | 1203 | 1345 | 1592 | 82° | 87° | 87° |